



EXHIBITION HALL

You dream it we host it

Pillarless, open-plan and light-filled venue opening out onto lush green spaces overlooking the historical Rosehill Gardens.

ENQUIRE NOW

**EXHIBITIONS • FAMILY DAYS •
INDOOR CONCERTS • CORPORATE TRAINING**



**ROSEHILL
GARDENS**

The Exhibition Hall has been home to many iconic events over the years. With high ceilings, a wealth of space, state-of-the-art connectivity and complementary amenities, it is ideal for lifestyle exhibitions, tradeshow, product launches, corporate training and music festivals. A space unlike any other in Sydney's West.



VENUE FEATURES

- 4000m2 of flexible carpeted indoor space
- Floor-to-ceiling glass allowing natural light in with spectacular racecourse views
- Adjoining outdoor terrace with close proximity to the lawn area
- Fully self contained
- Free high density WiFi
- Public address system
- Three phase and standard power
- Floor service pit grid approx 6m x 9m, with a total of 55pits
- Amenities Bar and café outlets
- Water and waste services
- Phone and data services
- Free onsite parking
- Onsite security

SUITABLE FOR

Trade Exhibitions & Consumer Shows, Special Events, Corporate Family Days, Cocktail Parties, Indoor Concerts & Festivals, Corporate Training, Exams

GROUND FLOOR

exhibition hall

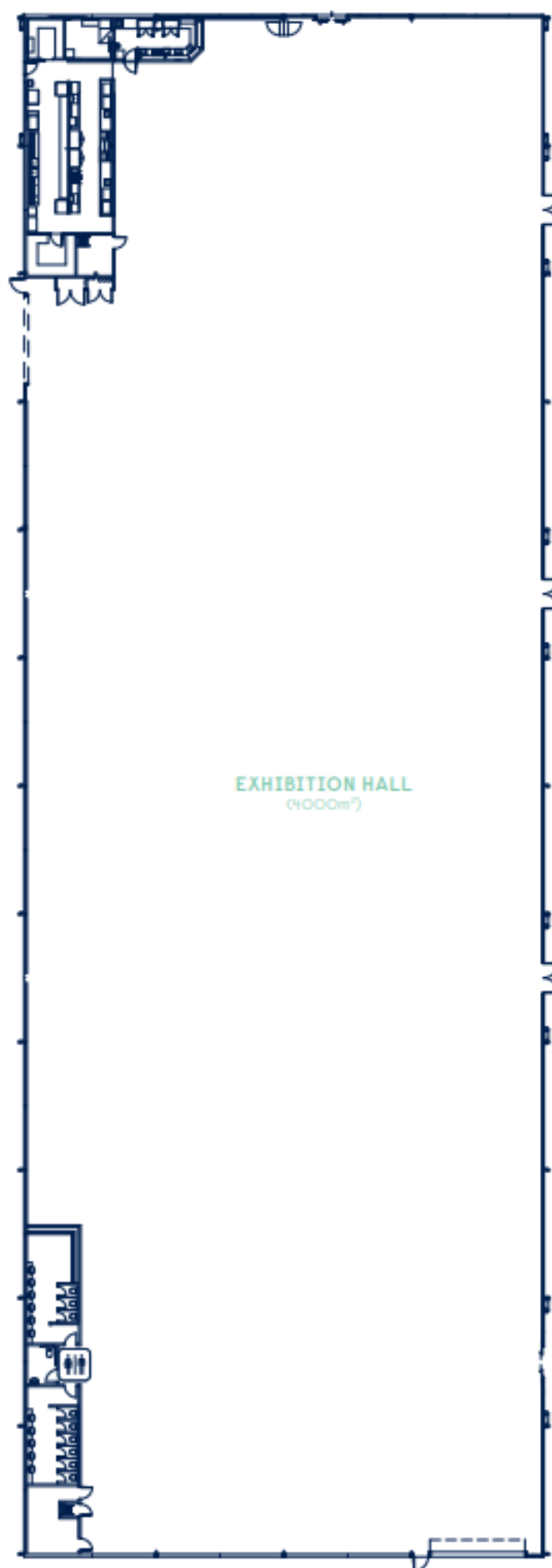

VENUE CAPACITY

THEATRE	2000
CLASSROOM	1000
COCKTAIL	2000
BANQUET	2000
EXAM	1300
EXHIBITION BOOTHS	183



ROSEHILL
GARDENS



ROSEHILL
GARDENS

**TO FIND OUT MORE PLEASE CONTACT OUR
MEETINGS & EVENTS TEAM**

P | 1300 729 668

E | meetingsandevents@australianurfclub.com.au